

Shock & Impact Testing Accelerometer

Dynamic

Sensitivity, typical, 25°C.....	1.5µ V/g
Acceleration range	100,000g peak
Amplitude nonlinearity.....	2%
Frequency response:	
±2 dB.....	0 - 50,000 Hz
Resonance frequency.....	300 kHz
Transverse sensitivity, max.....	5% of axial
Temperature response:	
-40°C.....	-10%
+85°C.....	+10%



Features

- ±10kg to ±100kg Range
- Environmentally Sealed
- mV Output
- Titanium Housing
- Hermetically Sealed
- Bolt Mounted

Electrical

Power voltage	2 - 10 VDC
Input impedance.....	3000~6000Ω
Output impedance.....	3000~6000Ω
Bias output voltage.....	± 100mV
Insulation(@ 100V).....	>100Mohm

Environmental

Temperature range.....	-50 to 120°C
Shock limit.....	100,000 g peak
Sealing	Hermetic

Physical

Sensing element design.....	MEMS
Weight.....	2 grams
Case material.....	Titanium
Mounting.....	Ø2.1 X 2

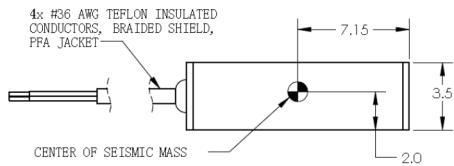
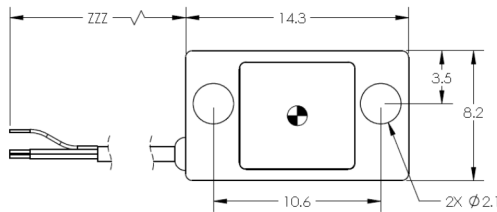

Accessories

- M2 mounting screw (or customers specified)
- Calibration certificate

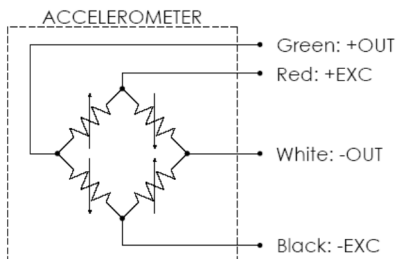

Ordering Information

