

Ex-ATEX accelerometer & thermometer



Features

- Ex-ATEX
- Corrosion resistant
- Hermetic seal
- Case isolated
- ESD protection
- Reverse wiring protection

Dynamic

Sensitivity, $\pm 10\%$, 25°C.....	100 mV/g
Acceleration range	80 g peak
Amplitude nonlinearity.....	1%
Frequency response:	
±1 dB.....	1 - 8,000 Hz
±3 dB.....	0.4 - 14,000 Hz
Resonance frequency.....	32 kHz
Transverse sensitivity, max.....	5% of axial
Temperature response:	
-50°C.....	-10%
+120°C.....	+10%

Electrical

Power requirement: voltage source	18 - 30 VDC
current regulating diode	2 - 10 mA
Residual noise, 2.5 Hz to 25 kHz.....	2 mg
Output impedance, max.....	100 Ω
Bias output voltage.....	12 VDC
Grounding.....	Case isolated

Temperature output

Sensitivity, typical.....	10mV/°C
Measure range.....	-40 to 125°C
Temperature accuracy.....	$\pm 1^\circ\text{C}$

Environmental

Temperature range.....	-50 to 125°C
Vibration limit.....	500 g peak
Shock limit.....	5,000 g peak
Electromagnetic sensitivity, equiv g, max	70 $\mu\text{g/gauss}$
Sealing	Hermetic
Base strain sensitivity, max.....	0.0002 g/ μstrain

Physical

Sensing element design.....	PZT ceramic/shear
Weight(W/O cable).....	105 grams
Case material.....	316L stainless steel
Mounting.....	1/4 - 28 UNF
Output connector.....	3 pin, MIL-C-5015
Mating connector.....	3 pin plug
Recommended cabling.....	20A

Accessories

Calibration certificate

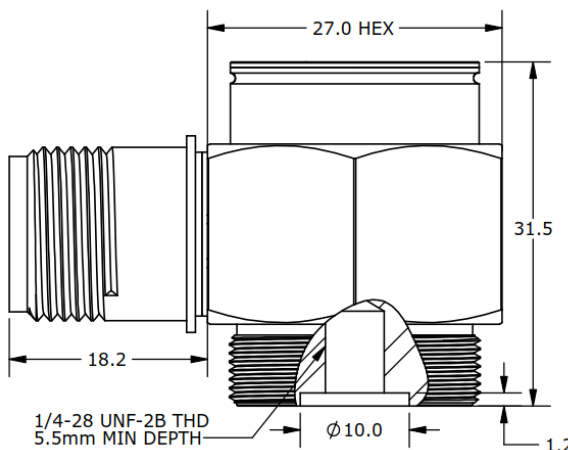
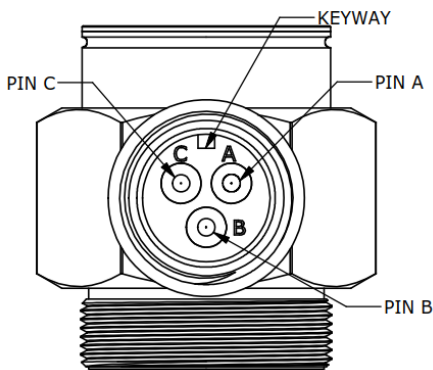
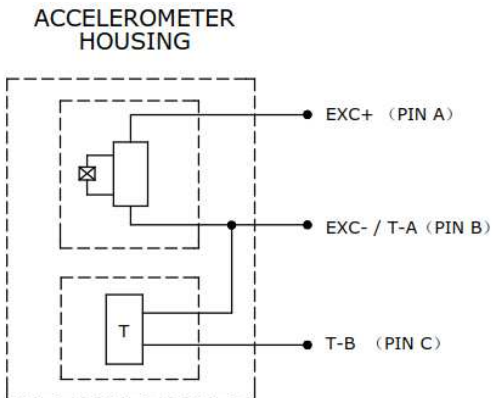

Ordering Information

